

PROJECT NAME	PHU KHAO HUA HIN RESIDENCE
LOCATION	SOI 102 HUA HIN, HUA HIN, PRACHUAP KHIRI KHAN Phu Khao Hua Hin Residence Village - Google Maps https://maps.app.goo.gl/6YWNM3UQXHqGJPL97?g_st=ac
PHASE	1
LAND AREA	1 - 82 - 0 RAI
PROJECT TYPE	SINGLE-STOREY LUXURY POOL VILLA
PROJECT START	SEPTEMBER 2025
TOTAL UNITS	4 RESIDENCES
LAND AREA	118.3 – 123.3 SQ.WAH. (473.2– 493.3 SQ.M.)
HOUSE FUNCTION	3 BEDROOMS 3 BATHROOMS
USEABLE AREA	321.92 SQ.M.
PRICE STARTS	17.15-17.5 MB.
PROJECT STATUST	construction completion on September 2026
CONTACT INFORMATION	Rada Property Management Co., Ltd. phone no. +66 (0) 88 261 6542 Line id 0882616542 WhatsApp +66 88 261 6542 E-mail: radamgmt.2020@gmail.com



PLOT	PLOT SIZE	USEABLE AREA	POOL SIZE	BEDROOM BATHROOM	PRICE (THB)
Plot. 1	473.2 sq.m. 118.3 sq.wa.	321.92 sq.m.	4.50 * 9 meter	3 Bedroom 3 Bathroom	17,157,500
Plot. 2	476.8 sq.m. 119.2 sq.wa.	321.92 sq.m.	4.50 * 9 meter	3 Bedroom 3 Bathroom	17,180,000
Plot. 3	479.2 sq.m. 119.8 sq.wa.	321.92 sq.m.	4.50 * 9 meter	3 Bedroom 3 Bathroom	17,195,000
Plot. 4	493.3 sq.m. 123.3 sq.wa.	321.92 sq.m.	4.50 * 9 meter	3 Bedroom 3 Bathroom	17,500,000

PAYMENT DETAILS

Construction Start After signing the contract. The construction plan will be completed within 1 month.

Completion Period 10 Months

Terms of Payment Booking 200,000 THB

Pay 20% for signing the contract. (After booking within 14 days)

Pay for the down payment in installments within 10 months.

Final payment on the ownership transfer date.

PROJECT DETAILS

The project has no common fees.

Public road access on two sides.

Title deed document (Red Chanote)

*The transfer of ownership costs are shared equally between the project and the buyer.



PHU KHAO
HUA HIN RESIDENCE
FLOOR PLAN

AREA SUMMARY

TOTAL USABLE AREA	328.09 SQM.
INTERNAL HOUSE AREA	192.05 SQM.
EXTERNAL HOUSE AREA	136.04 SQM.

Master bedroom	33.39 Sq.m.	Pump room	5.19 Sq.m.
Master bathroom & Walk-in Closet	21.19 Sq.m.	Storage	5.19 Sq.m.
Bedroom 2	22.95 Sq.m.	Covered pool terrace	59 Sq.m
Bathroom 2	5.7 Sq.m.	Swimming pool	40.5 Sq.m.
Bedroom 1	17.73 Sq.m.	Parking	36.54 Sq.m
Bathroom 1	5.73 Sq.m		
Living area, Dining area	65.94 Sq.m.		
Kitchen area	9.04 Sq.m.		

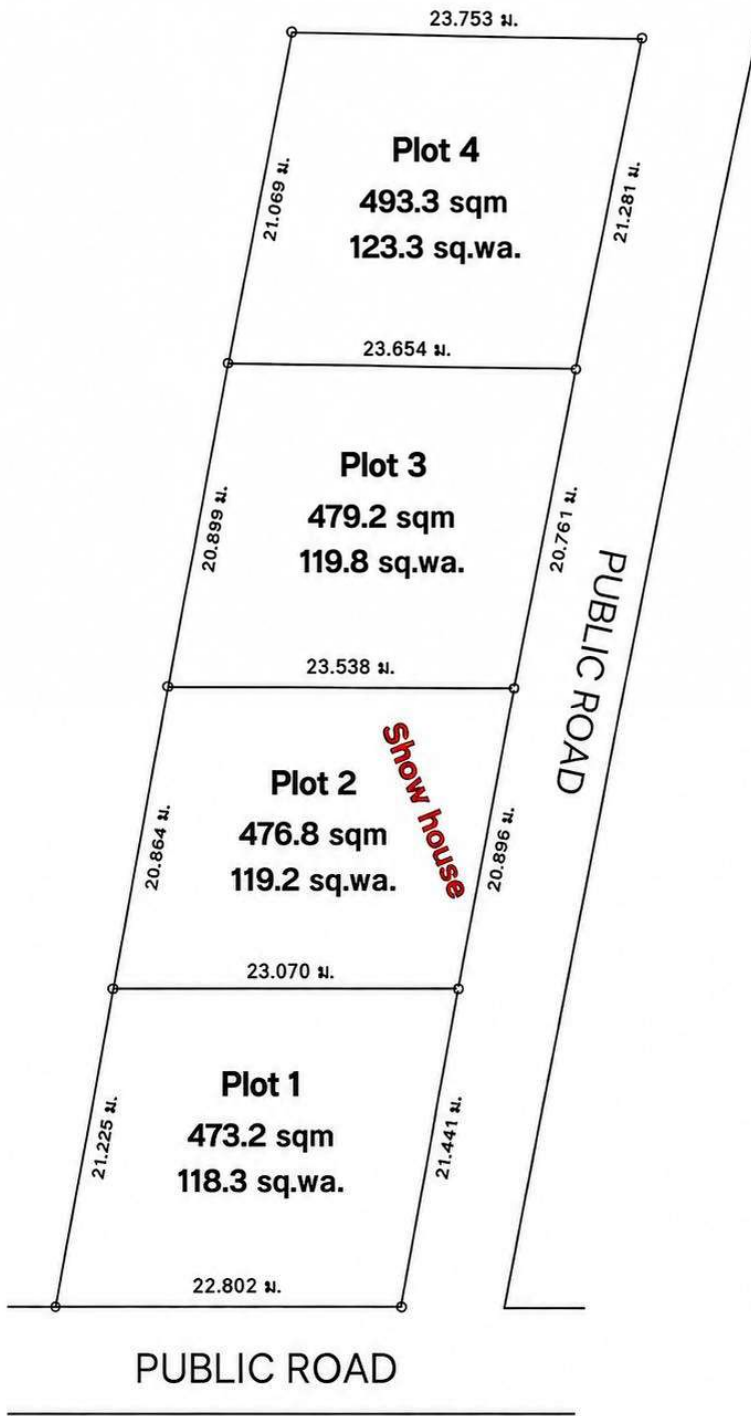

MASTER PLAN



Experience an elevated lifestyle at

PHU KHAO HUA HIN RESIDENCE VILLAGE

Defining Luxury Living in Hua Hin.

Phu Khao Hua Hin Residence is an exclusive collection of boutique luxury villas, perfectly located in one of Hua Hin's most desirable residential areas. Surrounded by serene natural mountain views, only minutes from the city's finest lifestyle destinations, the project offers a rare balance of privacy and convenience.



DESIGN



Located soi 102 Hua Hin Just 4 kilometers from Hua Hin Beach, residents enjoy easy access to shopping centers, Bangkok Hua- Hin hospital ,renowned restaurants, international schools, the premier golf courses and wellness destinations.

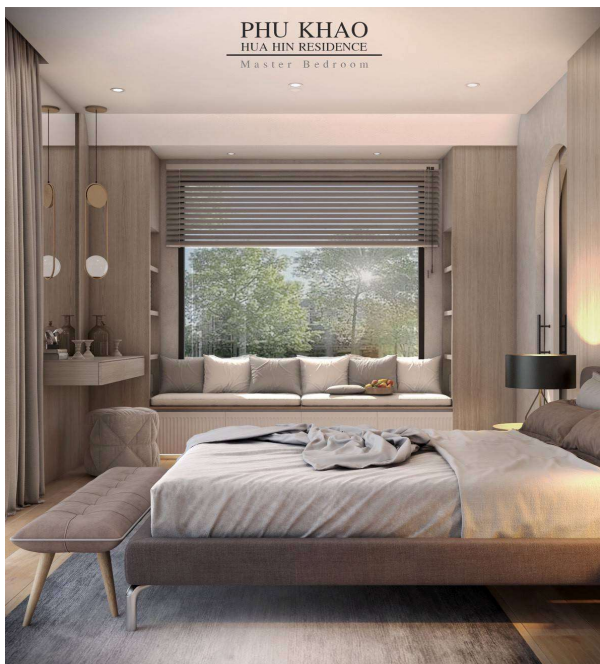

Each villa offers **328.09** sq.m. of refined living space, featuring elegant architectural lines, premium natural stone finishes, landscaped gardens, and a private pool terrace designed for sophisticated tropical living.



4.5 x 9 meter private swimming pool, complete with lounge seating and a transparent glass wall feature, creates a modern statement of understated luxury





INTERIOR

Inside, expansive open-plan interiors seamlessly connect the living, dining, and designer kitchen areas, creating a warm sophisticated atmosphere.



MASTER BEDROOM



The master suite is designed as a private calm, complete with a bathtub, walk-in closet, and a relaxing corner filled with natural light through floor-to-ceiling windows overlooking the private pool inspired by refined tropical boutique resort living.

Every detail reflects timeless design, thoughtful craftsmanship, and uncompromising quality. At Phu Khao Hua Hin Residence, home is not only about living well it is about location, lifestyle, and lasting value.

A rare opportunity to own a private villas in one of Hua Hin's most exclusive home.

INCLUSIONS

1. Built-in European kitchen & island come with electrical appliances such as hob & hood, an oven, a microwave, and a dishwasher*	✓
2. Built-in wardrobes all bedroom and cabinets under the sink in the toilets*	✓
3. The sloped swimming pool, size 4.5 * 9 meters depth 1.2 - 1.5 meters* with a transparent glass wall	✓
4. 3 wall-mounted A/C units and 1 ceiling cassette A/C (4-wayairflow)*	✓
5. Curtains throughout the house*	✓
6. A lawn installation around the house*	✓
7. Rain gutters UPVC around the house*	✓
8. Pest control pipes underground system*	✓
9. 9,000 liter underground water tank*	✓
10. Mitsubishi water pump 250w.*	✓
11. Video doorbell system	✓
12. Automatic remote gate	✓
13. 4 CCTV cameras*	✓
14. 5-year structural warranty*	✓
15. 1-year warranty on the swimming pool, and filter, and pump*	✓
16. Water meter and electric meter installation fees.	✓

*Terms and conditions apply. Subject to availability

